



London
North West
Healthcare
Charity

NHS

London North West
University Healthcare
NHS Trust

We need your help

To create a suite for bereaved parents



Spring
2025

Most women go into pregnancy expecting healthy babies, but sadly there are many couples who lose a baby

This has a devastating effect not just on the woman and her partner but also their wider family and friends.

Currently we do not have separate bespoke accommodation that allows privacy for families to grieve, and that's why we need your help.

Our proposed bereavement suite, the Myrtle Suite, will be a separate part of the labour ward, tucked away from the hustle and bustle. It will have a family room, kitchenette, double bedroom and ensuite bathroom, so families can spend time with their baby afterwards, in a private and peaceful space.

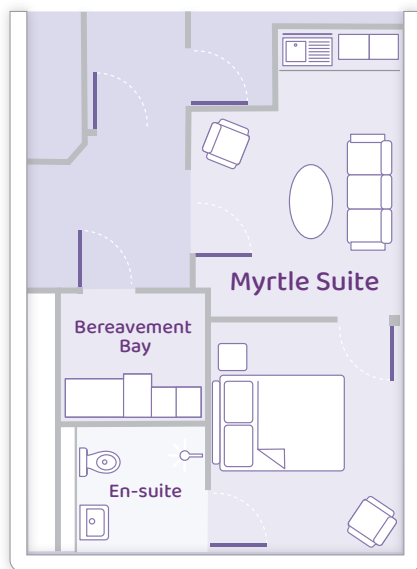

If you'd like to make a donation, please visit inwhcharity.org.uk/appeals

£150k – the cost to create our bereavement suite



What can you help pay for?

The suite is being funded by London North West Healthcare Charity (LNWH), but we can only do this through your kind donations.

The costs of some of the projects have been broken down into funding packages below.

If you'd like to make a general donation, visit lnwhcharity.org.uk/appeal or if you'd like to purchase one of the funding packages below, please get in touch with our fundraising team on **07775 778 343** or email lnwh-tr.charity@nhs.net

Funding packages	
Installation of new flooring throughout	£4,800
Fixtures and fittings, including cupboards and sink for the kitchenette	£3,200
Decorating all areas	£2,700
Installation of calming wall murals	£2,300
Fixtures and fittings in family areas	£1,300
Total	£14,300

Other funding packages are available.

If you'd like to make a donation, please visit lnwhcharity.org.uk/appeals

What does it feel like to give birth to a sleeping baby?

Priya is a busy working mum of three but her beautiful baby boy, Shayen was sadly born sleeping in August 2017.



"I woke up and I was in shock. Did that really happen? No... surely it was a dream... a nightmare."

"Knowing I was in a room surrounded by other rooms not far from me where other women were having babies, living babies, as I lay here with my dead baby, filled me with anxiety.



"My son, my baby boy, lay in a cold crib, not moving, not breathing. All my husband and I wanted was to spend those once in a lifetime moments making memories with our sleeping baby, in a warm, peaceful and thoughtful environment, instead of a room that was very cold and sterile.

"Those first moments and hours after losing your baby are the most important. It's a time that you never get back and the surroundings a loss parent is in can impact their healing journey.

"That's why I'm asking you to donate towards this bereavement suite, where parents can try to start to come to terms with their heartbreaking loss."



If you'd like to make a donation, please visit inwhcharity.org.uk/appeals

Email: inwh-tr.charity@nhs.net

Registered charity number: 1083634 Registered with the Fundraising Regulator